



Weston Public Library Board  
Special Meeting  
Space Planning Committee  
Wednesday, February 10, 2021, 3PM  
Via Zoom

### Agenda

1. Discussion/decision of furnishings for Children's Room.
2. Adjourn.

Weston Library is inviting you to a scheduled Zoom meeting.

Topic: SPC Meeting

Time: Feb 10, 2021 03:00 PM Eastern Time (US and Canada)

Join Zoom Meeting

<https://zoom.us/j/93590224699?pwd=bkxCV0JFVE9rSEYzdzdHQS95SGkwUT09>

Meeting ID: 935 9022 4699

Passcode: 06883

One tap mobile

+19292056099,,93590224699#,,,,\*06883# US (New York)

+13017158592,,93590224699#,,,,\*06883# US (Washington DC)



**Creative Library Concepts**  
P.O. Box 313  
Manalapan, NJ 07726 US  
+1 9082769200

# Proposal

CREATIVE LIBRARY CONCEPTS

**ADDRESS**

Weston Public Library  
56 Norfield Rd  
Weston, CT 06883

**SHIP TO**

Weston Public Library  
56 Norfield Rd  
Weston, CT 06883

PROPOSAL #	DATE
2826	12/21/2020

**SALESPERSON**

Charlie Cohen

ITEM #	DESCRIPTION	QTY	UNIT	TOTAL
	CT STATE CONTRACT # 14PSX0303 TMC SCHEDULE C INCLUDES FREIGHT & INSTALL 28% DISCOUNT			
L-1	SWIT11118BRZ Whistler Lounge Chair - Armless - Adult Dimensions: 26.5 in. W x 31.5 in. D x 32 in. H w/ 17.5 in. SH Material: Upholstery Grade Plywood w/ Upholstered Seat and Back Back Fabric: CF Stinson I Spy (APPROVED), Fabric Color: Red 63297 Back Yardage Required per Unit: 2.5 Yds. Seat Fabric: Carnegie Siltech Grain (APPROVED), Fabric Color: 6300-12 Seat Yardage Required per Unit: 3 Yds. Note: Order 1/3 more fabric for a repeating pattern. Legs: Brushed Aluminum	2	1,557.00	3,114.00
O-1	Round Ottoman Dimensions: 14 in. Dia x 12 in. H Material: Upholstery Grade Plywood w/ Upholstered Seat Side Fabric: Designtex Beguiled by the Wild (APPROVED, Fabric Color: Canary 3495-701 Side Yardage Required per Unit: 1.5 Yards Top Fabric: Carnegie Siltech Grain (APPROVED), Fabric Color: 6300-12 Top Yardage Required per Unit: .5 Yards Leg: None	4	809.00	3,236.00
L-2	Whistler Lounge Chair - Armless - Adult Dimensions: 26.5 in. W x 31.5 in. D x 32 in. H w/ 17.5 in. SH Material: Upholstery Grade Plywood w/ Upholstered Seat and Back Back Fabric: ArcCom Atomic (APPROVED), Fabric Color: Federal AC-61821-2 Back Yardage Required per Unit: 2.5 Yds. Seat Fabric: Designtex Silicone Element (APPROVED), Fabric Color: Splash 3919-407	2	1,596.00	3,192.00

ITEM #	DESCRIPTION	QTY	UNIT	TOTAL
O-2	<p>Seat Yardage Required per Unit: 3 Yds.  Note: Order 1/3 more fabric for a repeating pattern.  Legs: Brushed Aluminum</p> <p>Little Puddle Stool - 14 in.  Dimensions: 22.107 in.W x 23.953 in. D w/ 14 in. SH  Materials: .75 in. Plywood Frame w/ Upholstery; 1 in. MDF Base w/ Black Powder Coat  Side Fabric: Arc Com Atomic, Fabric Color: Federal AC-61821-2  Side Yardage Required per Unit: 2.5 yds.  Top Fabric: Carnegie Siltech Grain, Fabric Color: 6300-12  Top Yardage Required per Unit: 1 yds.</p>	1	792.00	792.00
O-3	<p>Little Puddle Stool - 16 in.  Dimensions: 22.107 in.W x 23.953 in. D w/ 16 in. SH  Materials: .75 in. Plywood Frame w/ Upholstery; 1 in. MDF Base w/ Black Powder Coat  Side Fabric: Arc Com Atomic, Fabric Color: Federal AC-61821-2  Side Yardage Required per Unit: 2.5 yds.  Top Fabric: Carnegie Siltech Grain, Fabric Color: 6300-12  Top Yardage Required per Unit: 1 yds.</p>	1	800.00	800.00
N-1	<p>Cube Reading Nook  Overall Dimensions: 30 in. W x 20 in. D x 60 in. H  Nook Opening: 28 in. W x ___ in. H x 20 in. D; ___ in. SH  Roof and Sides Material: .75 in. Plywood w/ Maple Veneer  Roof and Sides Edge: .125 in. Plywood Edgebanding 25  Front and Back Material: .75 in. Baltic Birch w/ Maple Veneer  (Shown) Edge Material: Exposed Ply 40  Nook Interior Material: Maple Veneer w/ 2 in. Thick Removable Medium-Density Foam Pad  Fabric: Architex Dapple, Fabric Color: Bayleaf  Yardage Requirement: 4 yards per unit  Finishing Option: All Clear  Roof Finish: Clear 01  Sides Finish: Clear 01  Nook Finish: Clear 01  Notes:  - Minimal pleats or facets in the foam pad.  - Upholstered foam pad on both sides and seat of Nook.  - Upholstered foam pad to sit proud of the front and back face, 1/4" - 3/8".  - Upholstered foam pad Velcroed and has a zipper closure.</p>	1	5,621.00	5,621.00
ST-1 (deleted)	<p>EnShell 24 in Adult Counter Perimeter Chair  Dimensions: 19.5 in W x 22.5 in D x 39.5 in H w/ 24 in Seat Height  Material: Plywood Shell with Forbo Linoleum and Maple Veneer  Metal Wire Stacker Sled Base  Perimeter Design: TBD  Forbo Color: Standard TBD  EnShell Handhold: HA  Shell Finish (Back Only): Clear 01  Base Color: Black A-PF11</p>	8	595.00	4,760.00
CH-2	<p>EnShell 18 in Adult Perimeter Chair  Dimensions: 19.5 in W x 22.5 in D x 33.5 in H w/ 18 in Seat Height  Material: Plywood Shell with Forbo Linoleum and Maple Veneer  Metal Wire Stacker Sled Base  Perimeter Design: TBD  Forbo Color: TMC Standard TBD</p>	2	447.12	894.24

ITEM #	DESCRIPTION	QTY	UNIT	TOTAL
T-1	<p>EnShell Handhold: HA  Shell Finish (Back Only): Clear 01  Base Color: Black A-PF11</p> <p>Kestrel Rectangle 24 in. x 60 in. Table w/ Laminate  Dimensions: 24 in. W x 60 in. L x 26 in. H  Material: 1.25 in. Premium Particle Board w/ TMC Standard Laminate  Laminate: Nevamar Grand Isle Maple  Edge Material: 1.25in Solid Wood Waterfall 31 (Rounded Corners)  Top Edge: .5in Radius; Bottom Edge: Eased  Edge Finish: Clear 01  Leg: Kestrel 26 in. H – Solid Maple Wood Leg; Squared and Tapered with Adjustable Glide  Leg Finish: Clear 01  MISC:  Half Modesty Panel - Veneer  (2) A-WM24 Wire Management Tray and (2) grommets</p>	1	2,149.00	2,149.00
T-2	<p>Round 36"-Dia ImPrinted Alphabet Table  Table Dimensions: 36"Dia x 20"H  Material: 1.25in Premium Particle Board w/ Maple Veneer  Table Surface: Maple Veneer w/Digital ImPrint Design  IMPG Design: Alphabet  Finish: Clear 01  Edge Material: .125 in. Maple Edgebanding 20  Edge Color: Clear 01  Square Well: None XX  Leg: Kestrel 20 in H - Squared and Tapered Wood  Leg Finish: Clear 01</p>	1	2,597.76	2,597.76
T-5-1	<p>Kestrel Wood Stool - 18 in. SH  Dimensions: 14 in. W x 14 in. D w/ 18 in. SH  Material: 1 in. Baltic Birch w/ Maple Veneer, Metal Understructure and Solid Maple Legs  Edge: Exposed Plywood 40  Seat/Edge Finish: Clear 01  Base Finish: Clear 01</p>	1	439.20	439.20
T-3	<p>Modified Barcelona Table - Round  Dimensions: 36"Dia x 36"H  Top Material: 1.125 in. Premium Particle Board w/ TMC Standard Laminate  Laminate: Nevamar Grand Isle Maple  Edge Material: 1.25 in. Solid Maple Waterfall 31  Top Edge: .5in Radius; Bottom Edge: Eased  Edge Finish: Clear 01  Base: Barcelona 36"H - Steel Column w/ Disc Bottom w/ Levelers  Base Finish: TMC Standard Powdercoat TBD</p>	2	1,596.00	3,192.00
T-4	<p>Kestrel Rectangle 24 in. x 66 in. Table w/ Laminate  Dimensions: 24 in. W x 66 in. L x 29 in. H  Material: 1.25 in. Premium Particle Board w/ TMC Standard Laminate  Laminate: Nevamar Grand Isle Maple  Edge Material: 1.25in Solid Wood Waterfall 31 (Rounded Corners)  Top Edge: .5in Radius; Bottom Edge: Eased  Edge Finish: Clear 01  Leg: Kestrel 29 in. H – Solid Maple Wood Leg; Squared and Tapered with Adjustable Glide</p>	1	2,183.00	2,183.00

ITEM #	DESCRIPTION	QTY	UNIT	TOTAL
CH-1	<p>Leg Finish: Clear 01  MISC:  Half Modesty Panel - Veneer  (2) A-WM24 Wire Management Tray and (2) grommets</p> <p>Lorca 16 in. Child Chair  Dimensions: 19 in. W x 18.25 in. D x 31 in. H w/ 16 in. Seat Height  Material: Plywood Shell w/ Maple Veneer, Powder Coated Metal  Legs and Nylon Glides  Cut-Out Design: None  Shell Finish: Aztec Red 110  Base Color: Black A-PF11  Glide Color: Black B</p>	2	265.68	531.36
B-1 (deleted)	<p>Upholstered Bench with Closed Base  Dimensions: 24"W x 24"D x 16"H  Materials: Veneered Plywood w. Upholstered Seat  Finish: TMC Standard Finish TBD  Fabric: dArchitex Dapple (APPROVED), Color: Bayleaf  Yardage Required: 1 yd per Unit  MISC:  Tack Glides</p>	1	1,262.16	1,262.16
SH11-12	<p>Mobile Open Square Display Filler Unit  Dimensions: 26"W x 26"D x 51.75"H  Materials: .75 in. Maple Veneer Plywood  Edge Material: .125 in. Maple Edgebanding 20  Finish: Clear 01  MISC:  (3) Fixed Shelves  3 in. Dia Locking Casters - Hidden</p>	1	1,473.12	1,473.12
SH-1	<p>Metal Fixed Shelving Units - Single-Faced  Dimensions:  (2) 36 in. W x 54 in. H  (2) 30 in. W x 54 in. H  (4) Ventilation Bases for Existing shelving  Color: 159 Eggshell</p> <p>HEPXX126020  Plain End Panel (2)  Dimensions: 11.5 in. W x 55.5 in. H  Material: 1.25 in. Premium Particle Board w/ Maple Veneer  Edge Material: .125 in. Maple Edgebanding 20 - 4 Edges  Finish: Clear 01</p> <p>HCTL1213220  Shelving Canopy Top w/ Laminate (1)  Dimensions: 132.25 in. L x 11.5 in. W x 1.25 in. Thick  Material: 1.125 in. Premium Particle Board w/ Laminate  Laminate: Nevamar Grand Isle Maple  Back Surface: Polybac Backer  Edge Material: .125 in. Maple Edgebanding 20 - 4 Edges  Edge Finish: Clear 01  Note: Split in 2 @ 66.125 in.</p>	1	2,992.32	2,992.32
SH-2	<p>Metal Fixed Shelving Units - Single-Faced  Dimensions:  (1) 36 in. W x 42 in. H  (2) 30 in. W x 42 in. H</p>	1	1,880.64	1,880.64

ITEM #	DESCRIPTION	QTY	UNIT	TOTAL
	(3) Ventilatoin Bases for Existing Shelving Color: 159 Eggshell			
	HEPXX124820 Plain End Panel (1) Dimensions: 11.5 in. W x 43.5 in. H Material: 1.25 in. Premium Particle Board w/ Maple Veneer Edge Material: .125 in. Maple Edgebanding 20 - 4 Edges Finish: Clear 01			
	HCTL1210820 Shelving Canopy Top w/ Laminate (1) Dimensions: 96.1875 in. L x 11.5 in. W x 1.25 in. Thick Material: 1.125 in. Premium Particle Board w/ Laminate Laminate: Nevamar Grand Isle Maple Back Surface: Polybac Backer Edge Material: .125 in. Maple Edgebanding 20 - 4 Edges Edge Finish: Clear 01			
SH-3	Metal Fixed Shelving Units - Single-Faced Dimensions: (2) 36 in. W x 66 in. H (1) 30 in. W x 66 in. H Color: 159 Eggshell	1	1,853.28	1,853.28
	HEPXX127220 Plain End Panel (1) Dimensions: 11.5 in. W x 67.5 in. H Material: 1.25 in. Premium Particle Board w/ Maple Veneer Edge Material: .125 in. Maple Edgebanding 20 - 4 Edges Finish: Clear 01			
	HCTL1210820 Shelving Canopy Top w/ Laminate (1) Dimensions: 102.1875 in. L x 11.5 in. W x 1.25 in. Thick Material: 1.125 in. Premium Particle Board w/ Laminate Laminate: Nevamar Grand Isle Maple Back Surface: Polybac Backer Edge Material: .125 in. Maple Edgebanding 20 - 4 Edges Edge Finish: Clear 01			
SH-4	Metal Fixed Shelving Units - Single-Faced Dimensions: (1) 36 in. W x 84 in. H Color: 159 Eggshell	1	1,276.56	1,276.56
	HEPXX129020 Plain End Panel (2) Dimensions: 11.5 in. W x 85.5 in. H Material: 1.25 in. Premium Particle Board w/ Maple Veneer Edge Material: .125 in. Maple Edgebanding 20 - 4 Edges Finish: Clear 01			
SH-5	Metal Fixed Shelving Units - Single-Faced Dimensions: (2) 30 in. W x 42 in. H Color: 159 Eggshell	1	1,392.48	1,392.48

ITEM #	DESCRIPTION	QTY	UNIT	TOTAL
SH-6	<p>Metal Filler Unit  Dimensions:  (1) 10 in. W x 10 in. D x 42 in. H  Color: 159 Eggshell</p>			
	<p>HEPXX124820  Plain End Panel (1)  Dimensions: 11.5 in. W x 43.5 in. H  Material: 1.25 in. Premium Particle Board w/ Maple Veneer  Edge Material: .125 in. Maple Edgebanding 20 - 4 Edges  Finish: Clear 01</p>			
	<p>HCTL127220  Shelving Canopy Top w/ Laminate (1)  Dimensions: 60.125 in. L x 11.5 in. W x 1.25 in. Thick  Material: 1.125 in. Premium Particle Board w/ Laminate  Laminate: Nevamar Grand Isle Maple  Back Surface: Polybac Backer  Edge Material: .125 in. Maple Edgebanding 20 - 4 Edges  Edge Finish: Clear 01</p>			
	<p>Metal Fixed Shelving Units - Single-Faced  Dimensions:  (2) 30 in. W x 66 in. H  (2) 36 in. W x 66 in. H  Color: 159 Eggshell</p>	1	4,260.24	4,260.24
	<p>HEPXX127220  Plain End Panel (5)  Dimensions: 11.5 in. W x 67.5 in. H  Material: 1.25 in. Premium Particle Board w/ Maple Veneer  Edge Material: .125 in. Maple Edgebanding 20 - 4 Edges  Finish: Clear 01</p>			
	<p>HCTL1210820  Shelving Canopy Top w/ Laminate (1)  Dimensions: 78.125 in. L x 11.5 in. W x 1.25 in. Thick  Material: 1.125 in. Premium Particle Board w/ Laminate  Laminate: Nevamar Grand Isle Maple  Back Surface: Polybac Backer  Edge Material: .125 in. Maple Edgebanding 20 - 4 Edges  Edge Finish: Clear 01</p>			
	<p>HCTL127220  Shelving Canopy Top w/ Laminate (2)  Dimensions: 36.0625 in. L x 11.5 in. W x 1.25 in. Thick  Material: 1.125 in. Premium Particle Board w/ Laminate  Laminate: Nevamar Grand Isle Maple  Back Surface: Polybac Backer  Edge Material: .125 in. Maple Edgebanding 20 - 4 Edges  Edge Finish: Clear 01</p>			
	<p>HCTL127220  Shelving Canopy Top w/ Laminate (2)  Dimensions: 36.0625 in. L x 11.5 in. W x 1.25 in. Thick  Material: 1.125 in. Premium Particle Board w/ Laminate  Laminate: Nevamar Grand Isle Maple</p>			

ITEM #	DESCRIPTION	QTY	UNIT	TOTAL
SH-7	<p>Back Surface: Polybac Backer Edge Material: .125 in. Maple Edgebanding 20 - 4 Edges</p> <p>Metal Fixed Shelving Units - Single-Faced Dimensions: (5) 36 in. W x 54 in. H Color: 159 Eggshell</p> <p>HEPXX126020 Plain End Panel (1) Dimensions: 10.5 in. W x 55.5 in. H Material: 1.25 in. Premium Particle Board w/ Maple Veneer Edge Material: .125 in. Maple Edgebanding 20 - 4 Edges Finish: Clear 01</p> <p>HCTL1218020 Shelving Canopy Top w/ Laminate (1) Dimensions: 180.3125 in. L x 10.5 in. W x 1.25 in. Thick Material: 1.125 in. Premium Particle Board w/ Laminate Laminate: Nevamar Grand Isle Maple Back Surface: Polybac Backer Edge Material: .125 in. Maple Edgebanding 20 - 4 Edges Edge Finish: Clear 01</p>	1	3,716.64	3,716.64
SH-8	<p>Metal Fixed Shelving Units - Single-Faced Dimensions: (4) 36 in. W x 54 in. H (3) 30 in. W x 54 in. H (7) Ventilation Bases for Existing Shelving Color: 159 Eggshell</p> <p>HEPXX126020 Plain End Panel (1) Dimensions: 11.5 in. W x 55.5 in. H Material: 1.25 in. Premium Particle Board w/ Maple Veneer Edge Material: .125 in. Maple Edgebanding 20 - 4 Edges Finish: Clear 01</p> <p>HCTL1223420 Shelving Canopy Top w/ Laminate (1) Dimensions: 234.4375 in. L x 11.5 in. W x 1.25 in. Thick Material: 1.125 in. Premium Particle Board w/ Laminate Laminate: Nevamar Grand Isle Maple Back Surface: Polybac Backer Edge Material: .125 in. Maple Edgebanding 20 - 4 Edges Edge Finish: Clear 01</p>	1	4,783.68	4,783.68
SH-9	<p>Metal Fixed Shelving Units - Single-Faced Dimensions: (4) 36 in. W x 48 in. H (3) 30 in. W x 48 in. H (5) Ventilation Bases for Existing Shelvin Color: 159 Eggshell</p> <p>Metal Filler Unit Dimensions: (1) 12 in. W x 12 in. D x 48 in. H Color: 159 Eggshell</p>	1	3,720.24	3,720.24



ITEM #	DESCRIPTION	QTY	UNIT	TOTAL
SH-10	<p>HEPXX185420 Plain End Panel (1) Dimensions: 13.5 in. W x 49.5 in. H Material: 1.25 in. Premium Particle Board w/ Maple Veneer Edge Material: .125 in. Maple Edgebanding 20 - 4 Edges Finish: Clear 01</p> <p>HCTL1818620 Shelving Canopy Top w/ Laminate (1) Dimensions: 186.3125 in. L x 13.5 in. W x 1.25 in. Thick Material: 1.125 in. Premium Particle Board w/ Laminate Laminate: Nevamar Grand Isle Maple Back Surface: Polybac Backer Edge Material: .125 in. Maple Edgebanding 20 - 4 Edges Edge Finish: Clear 01</p>	1	4,016.88	4,016.88
	<p>Metal Mobile Shelving Units - Double-Faced Dimensions: (2) 36 in. W x 48 in. H Color: 159 Eggshell</p>			
	<p>HEPXX305420 Plain End Panel (2) Dimensions: 26 in. W x 51.75 in. H Material: 1.25 in. Premium Particle Board w/ Maple Veneer Edge Material: .125 in. Maple Edgebanding 20 - 4 Edges Finish: Clear 01</p> <p>HCTL3010820 Shelving Canopy Top w/ Laminate (1) Dimensions: 72.125 in. L x 26 in. W x 1.25 in. Thick Material: 1.125 in. Premium Particle Board w/ Laminate Laminate: Nevamar Grand Isle Maple Back Surface: Polybac Backer Edge Material: .125 in. Maple Edgebanding 20 - 4 Edges Edge Finish: Clear 01</p>			
SH-11	<p>Metal Mobile Shelving Units - Double-Faced Dimensions: (1) 36 in. W x 48 in. H Color: 159 Eggshell</p>	1	2,792.16	2,792.16
	<p>HEPXX305420 Plain End Panel (2) Dimensions: 26 in. W x 51.75 in. H Material: 1.25 in. Premium Particle Board w/ Maple Veneer Edge Material: .125 in. Maple Edgebanding 20 - 4 Edges Finish: Clear 01</p>			
	<p>HCTL307220 Shelving Canopy Top w/ Laminate (1) Dimensions: 36.0625 in. L x 26 in. W x 1.25 in. Thick Material: 1.125 in. Premium Particle Board w/ Laminate Laminate: Nevamar Grand Isle Maple Back Surface: Polybac Backer Edge Material: .125 in. Maple Edgebanding 20 - 4 Edges Edge Finish: Clear 01</p>			

ITEM #	DESCRIPTION	QTY	UNIT	TOTAL
SH-12	<p>Metal Mobile Shelving Units - Double-Faced  Dimensions:  (1) 36 in. W x 48 in. H  Color: 159 Eggshell</p> <p>HEPXX305420  Plain End Panel (2)  Dimensions: 26 in. W x 51.75 in. H  Material: 1.25 in. Premium Particle Board w/ Maple Veneer  Edge Material: .125 in. Maple Edgebanding 20 - 4 Edges  Finish: Clear 01</p> <p>HCTL307220  Shelving Canopy Top w/ Laminate (1)  Dimensions: 36.0625 in. L x 26 in. W x 1.25 in. Thick  Material: 1.125 in. Premium Particle Board w/ Laminate  Laminate: Nevamar Grand Isle Maple  Back Surface: Polybac Backer  Edge Material: .125 in. Maple Edgebanding 20 - 4 Edges  Edge Finish: Clear 01</p>	1	2,792.16	2,792.16
SH-13	<p>Metal Mobile Shelving Units - Double-Faced  Dimensions:  (2) 36 in. W x 48 in. H  Color: 159 Eggshell</p> <p>HEPXX305420  Plain End Panel (2)  Dimensions: 26 in. W x 51.75 in. H  Material: 1.25 in. Premium Particle Board w/ Maple Veneer  Edge Material: .125 in. Maple Edgebanding 20 - 4 Edges  Finish: Clear 01</p> <p>HCTL3010820  Shelving Canopy Top w/ Laminate (1)  Dimensions: 72.125 in. L x 26 in. W x 1.25 in. Thick  Material: 1.125 in. Premium Particle Board w/ Laminate  Laminate: Nevamar Grand Isle Maple  Back Surface: Polybac Backer  Edge Material: .125 in. Maple Edgebanding 20 - 4 Edges  Edge Finish: Clear 01</p>	1	4,016.88	4,016.88
SH-14	<p>Metal Fixed Shelving Units - Double-Faced  Dimensions:  (4) 36 in. W x 54 in. H  Color: 159 Eggshell</p> <p>Custom Display End Panels (1)  Dimensions: 21 in. W x 3.5 in. D x 55.5 in. H  Material: .75 in. Plywood Panels w/ Premium Maple Veneer  Shelves: 3 Fixed Shelves  Unit Edge Material: .125 in. Maple Edgebanding 20  Shelf Edge Material: .5 in x 1.25 in. Book Stop Edge  Finish: Clear 01</p> <p>HEPXX246020  Plain End Panel (1)  Dimensions: 21"w x 55.5"H</p>	1	4,960.08	4,960.08

ITEM #	DESCRIPTION	QTY	UNIT	TOTAL
SH-15	<p>Material: 1.25" Premium Particle Board w/ Maple Veneer Edge Material: .125" Maple Edgebanding 20- 4 edges Finish: Clear 01</p> <p>HCTL2414420 Shelving Canopy Top w/ Laminate (1) Dimensions: 144.25 in. L x 21 in. W x 1.25 in. Thick Material: 1.125 in. Premium Particle Board w/ Laminate Laminate: Nevamar Grand Isle Maple Back Surface: Polybac Backer Edge Material: .125 in. Maple Edgebanding 20 - 4 Edges Edge Finish: Clear 01 Note: Split in 2 @ 72.125 in.</p> <p>Metal Fixed Shelving Units - Double-Faced Dimensions: (4) 36 in. W x 66 in. H Color: 159 Eggshell</p> <p>Custom Display End Panel (1) Dimensions: 21 in. W x 3.5 in. D x 67.5 in. H Material: .75 in. Plywood Panels w/ Premium Maple Veneer Shelves: 3 Fixed Shelves Unit Edge Material: .125 in. Maple Edgebanding 20 Shelf Edge Material: .5 in x 1.25 in. Book Stop Edge Finish: Clear 01</p> <p>HEPXX247220 Plain End Panel (1) Dimensions: 21 in. W x 67.5 in. H Material: 1.25 in. Premium Particle Board w/ Maple Veneer Edge Material: .125 in. Maple Edgebanding 20 - 4 Edges Finish: Clear 01</p> <p>HCTL2414420 Shelving Canopy Top w/ Laminate (1) Dimensions: 144.25 in. L x 21 in. W x 1.25 in. Thick Material: 1.125 in. Premium Particle Board w/ Laminate Laminate: Nevamar Grand Isle Maple Back Surface: Polybac Backer Edge Material: .125 in. Maple Edgebanding 20 - 4 Edges Edge Finish: Clear 01 Note: Split in 2 @ 72.125 in.</p>	1	5,381.28	5,381.28
SH-16	<p>Metal Fixed Shelving Units - Double-Faced Dimensions: (5) 36 in. W x 66 in. H Color: 159 Eggshell</p> <p>Custom Display End Panel (1) Dimensions: 21 in. W x 3.5 in. D x 67.5 in. H Material: .75 in. Plywood Panels w/ Premium Maple Veneer Shelves: 3 Fixed Shelves Unit Edge Material: .125 in. Maple Edgebanding 20 Shelf Edge Material: .5 in x 1.25 in. Book Stop Edge Finish: Clear 01</p> <p>HEPXX247220</p>	1	6,275.52	6,275.52

ITEM #	DESCRIPTION	QTY	UNIT	TOTAL
	Plain End Panel (1) Dimensions: 21"w x 67.5"H Material: 1.25" Premium Particle Board w/ Maple Veneer Edge Material: .125" Maple Edgebanding 20- 4 Edges Finish: Clear 01  HCTL2421020 Shelving Canopy Top w/ Laminate (1) Dimensions: 210.3125 in. L x 21 in. W x 1.25 in. Thick Material: 1.125 in. Premium Particle Board w/ Laminate Laminate: Nevamar Grand Isle Maple Back Surface: Polybac Backer Edge Material: .125 in. Maple Edgebanding 20 - 4 Edges Edge Finish: Clear 01 Note: Split in 2 @ 105.15625 in.			
SH-17	Metal Fixed Shelving Units - Double-Faced Dimensions: (3) 36 in. W x 54 in. H Color: 159 Eggshell	1	4,001.76	4,001.76
	Custom Display End Panel (1) Dimensions: 21 in. W x 3.5 in. D x 55.5 in. H Material: .75 in. Plywood Panels w/ Premium Maple Veneer Shelves: 3 Fixed Shelves Unit Edge Material: .125 in. Maple Edgebanding 20 Shelf Edge Material: .5 in x 1.25 in. Book Stop Edge Finish: Clear 01  HEPXX246020 Plain End Panel (1) Dimensions: 21"w x 55.5"H Material: 1.25" Premium Particle Board w/ Maple Veneer Edge Material: .125" Maple Edgebanding 20- 4 edges  HCTL2411520 Shelving Canopy Top w/ Laminate (1) Dimensions: 108.1875 in. L x 21 in. W x 1.25 in. Thick Material: 1.125 in. Premium Particle Board w/ Laminate Laminate: Nevamar Grand Isle Maple Back Surface: Polybac Backer Edge Material: .125 in. Maple Edgebanding 20 - 4 Edges Edge Finish: Clear 01			
Office	Trendway Office	1	8,140.00	8,140.00
INSTALLATION	For Trendway Glass wall	1	2,270.00	2,270.00
Steel SURCHARGE		1	529.00	529.00

FABRIC IS INCLUDED

TOTAL

**\$107,288.64**

Accepted By

Accepted Date

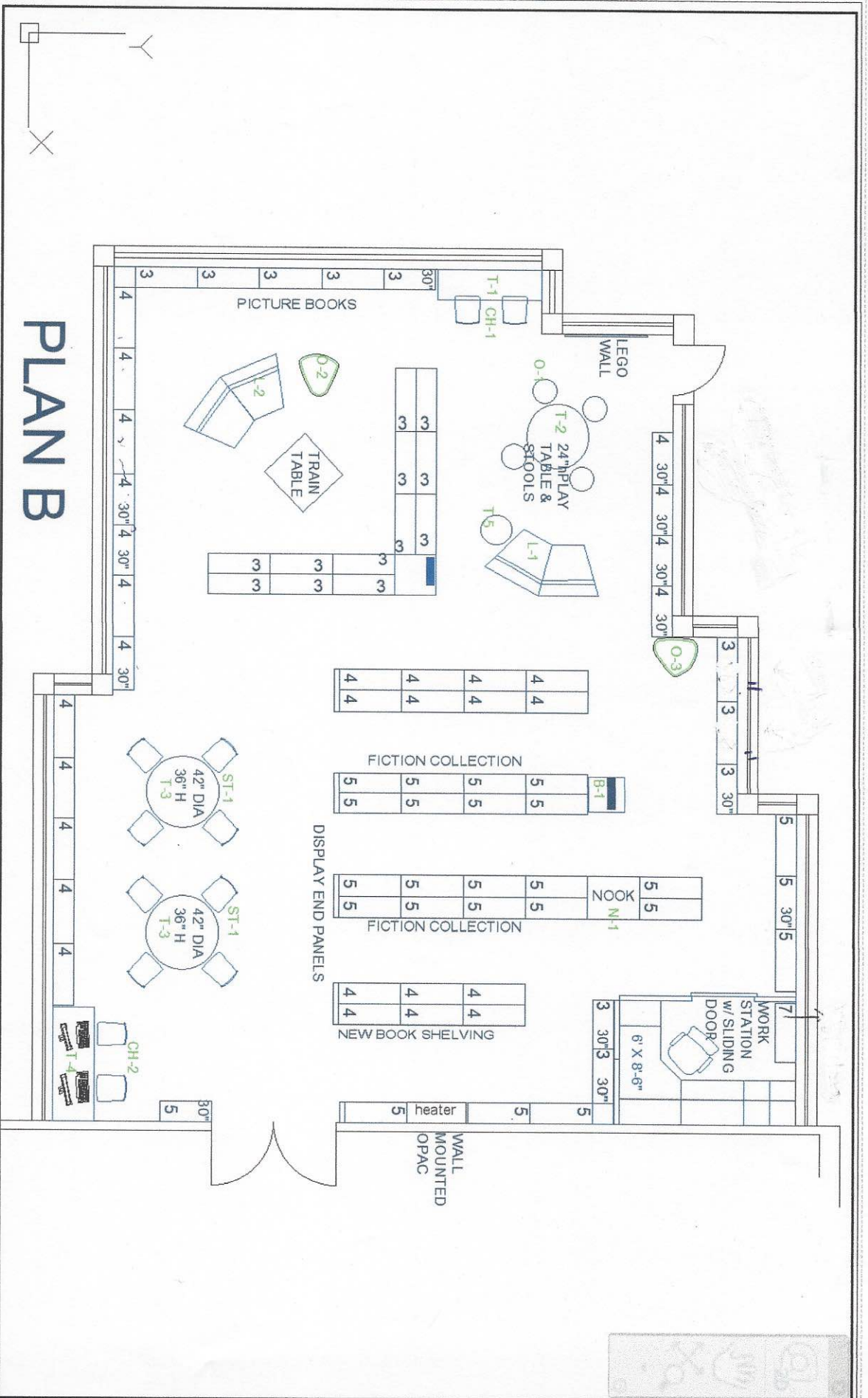

# PLAN B

This design is owned by Creative Library Concepts, and is protected from unauthorized use, copying and dissemination by copyright and other intellectual property laws. All rights reserved. The design or accompanying documents shall be construed as a contract only when used in conjunction with any other written or oral agreement. Any unauthorized use, reproduction, modification, or distribution of this plan shall be held liable to the fullest extent of the law. All other rights reserved. © Creative Library Concepts.

CLIENT: WESTON PUBLIC LIBRARY  
 56 Norfield Rd, Weston CT 06883  
 PROJECT: Library Renovation  
 DESIGNER: n. dalzell  
 DATE: 7.15.18  
 SCALE: nts



Copyright: 2015 C.C. All rights reserved									
--	--	--	--	--	--	--	--	--	--

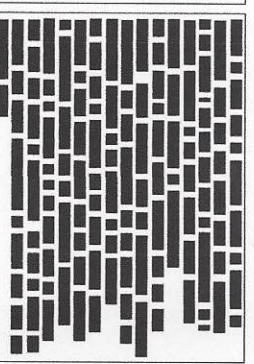



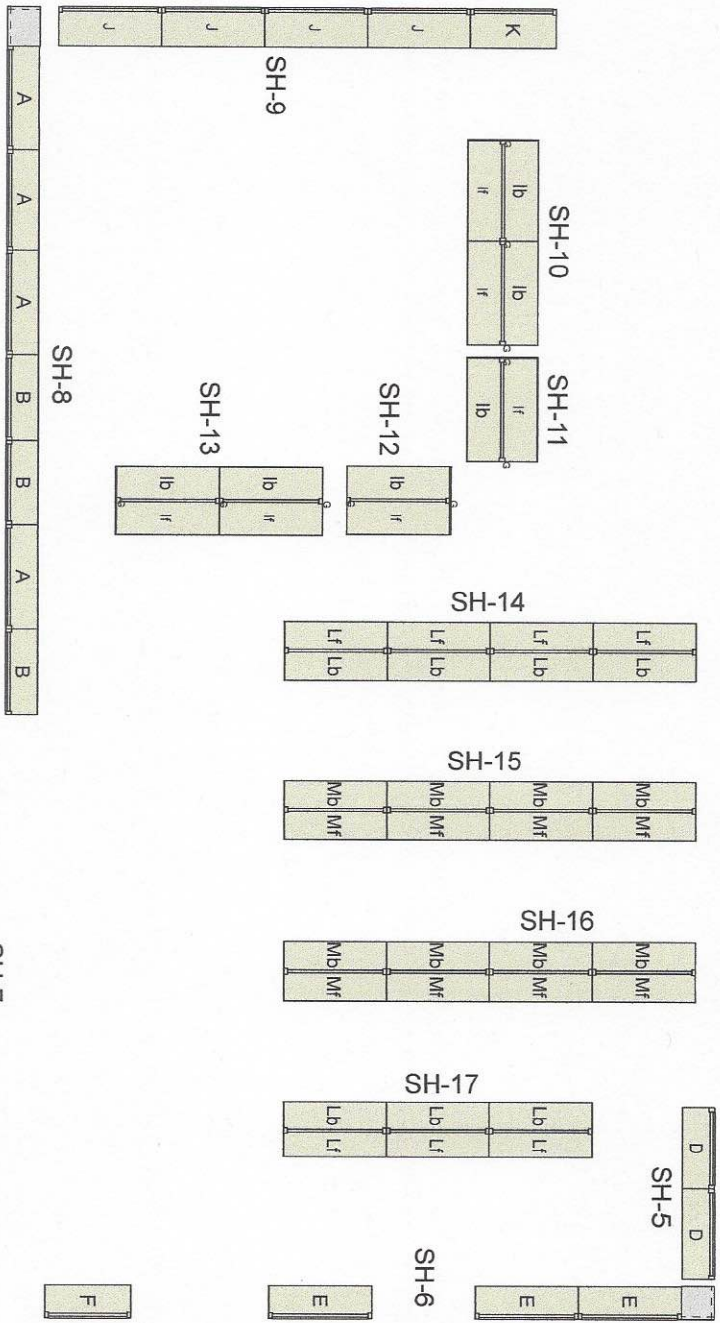
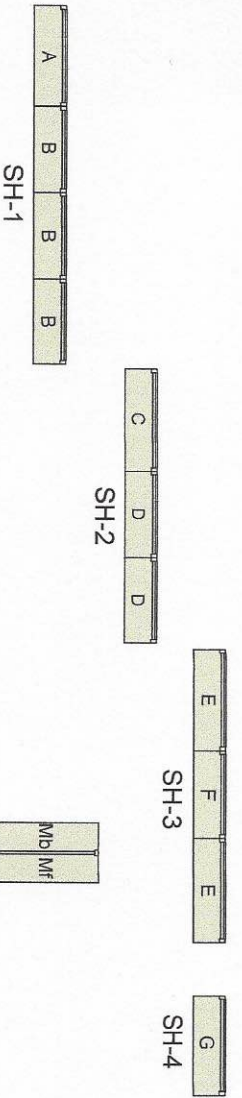

3002 N. Burdick Street Kalamazoo, MI 49004  
 PH: (603) 895-3991 FAX:

Project Name: Weston Public Library		Customer Name: TMC Furniture, Inc.	
Address:		View:	
Approved By:		Room:	
Date:		Printed:	
Scale: 1:65		Drawn By: Mark DeBruyere	
Version:		Expiration:	
Price File: 11182019		Version: Borroughs 9.21 Configurats 71	
Page: 1		Printed: 12/17/2019	

Not included in this proposal: Installation, Taxes, Engineering, and Permits of any kind that may be required. Pricing is based on ordering material in one of Borroughs Standard Colors. The lead-time is currently 4-5 weeks after receipt of an order to begin shipping. Standard Borroughs Terms and Conditions apply. This quote is good for 12 days.

This Drawing And All Information Is The Expressed Property Of Borroughs Corporation. Do Not Use Or Copy Without Written Permission From Borroughs Corporation. Drawing Is Subject To Return On Demand

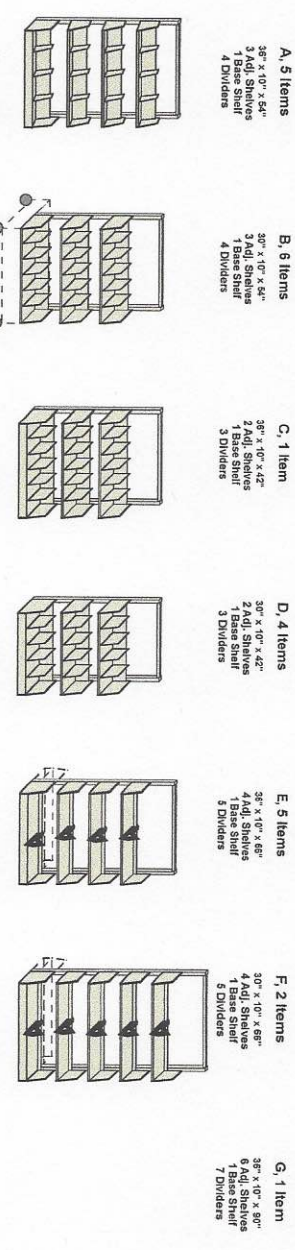
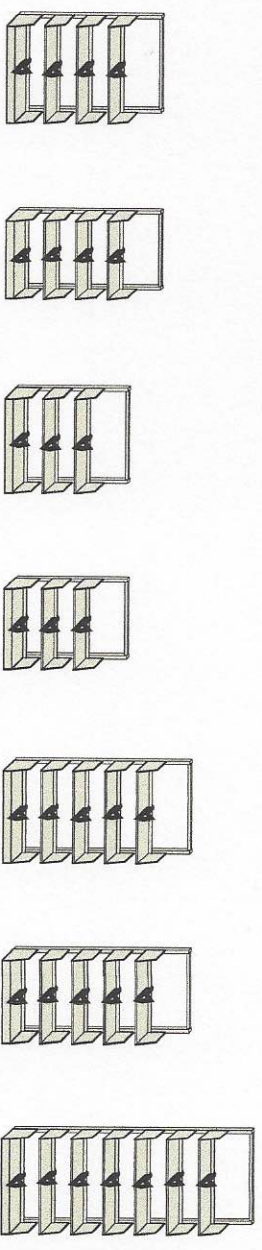

3002 N. Burdick Street Kalamazoo, MI 49004  
 PH: (603) 895-3991 FAX:

This Drawing And All Information Is The Expressed Property Of Borroughs Corporation.  
 Do Not Use Or Copy Without Written Permission From Borroughs Corporation.  
 Drawing Is Subject To Return On Demand

Project Name: Weston Public Library		Customer Name: TMC Furniture, Inc.	
Address:		View:	
Approved By:		Room:	
Date:		Printed:	
Scale: 1:70		Drawn By: Mark DeBruyere	
Version:		Expiration:	
Price File: 11142019		Version: Borroughs 821 Configs 71	
Page: 1		Price File: 11142019	
		Page: 1	





**Creative Library Concepts**  
 P.O. Box 313  
 Manalapan, NJ 07726  
 (908) 276-9200

**Proposal**

**ADDRESS**  
 Weston Public Library  
 56 Norfield Rd  
 Weston, CT 06883

**SHIP TO**  
 Weston Public Library  
 56 Norfield Rd  
 Weston, CT 06883

PROPOSAL #	DATE	EXPIRATION DATE
2089	01/03/2019	04/03/2019

**TRACKING NO.**

Book Carts

**SALESPERSON**

Charlie Cohen

ITEM #	DESCRIPTION	QTY	UNIT	TOTAL
1.	Rental of book carts for 1 week. (38) double sided mobile library carts. Each side will have a total of 4 shelves. Each cart will have 8 shelves	1	1,014.00	1,014.00
2.	freight	1	333.00	333.00
3.	dismantle 52 sections, ep , cp , scrap on site Weston Public Library to provide a dumpster	1	2,080.00	2,080.00

\*INSTALLER OR CUSTODIAN MUST BE ON SITE TO REMOVE CARTS AND ROLL THEM TO THE LOCATION.

**TOTAL**

**\$3,427.00**

\*A \$5,000 DEPOSIT IS REQUIRED AND WILL BE REFUNDED WHEN THE CARTS ARE RETURNED.

Accepted By

Accepted Date



**Creative Library Concepts**  
 P.O. Box 313  
 Manalapan, NJ 07726  
 (908) 276-9200

# Proposal

**ADDRESS**  
 Weston Public Library  
 56 Norfield Rd  
 Weston, CT 06883

**SHIP TO**  
 Weston Public Library  
 56 Norfield Rd  
 Weston, CT 06883

PROPOSAL #	DATE	EXPIRATION DATE
2089	01/03/2019	04/03/2019

**TRACKING NO.**  
 Book Carts

**SALESPERSON**  
 Charlie Cohen

ITEM #	DESCRIPTION	QTY	UNIT	TOTAL
1.	Rental of book carts for 1 week. (38) double sided mobile library carts. Each side will have a total of 4 shelves. Each cart will have 8 shelves	1	1,014.00	1,014.00
2.	freight	1	333.00	333.00

\*INSTALLER OR CUSTODIAN MUST BE ON SITE TO REMOVE CARTS AND ROLL THEM TO THE LOCATION.

**TOTAL**

**\$1,347.00**

\*A \$5,000 DEPOSIT IS REQUIRED AND WILL BE REFUNDED WHEN THE CARTS ARE RETURNED.

Accepted By

Accepted Date



Creative Library Concepts  
 P.O. Box 313  
 Manalapan, NJ 07726 US  
 +1 9082769200

**Proposal**

ADDRESS
Weston Public Library 56 Norfield Rd Weston, CT 06883

SHIP TO
Weston Public Library 56 Norfield Rd Weston, CT 06883

PROPOSAL #	DATE	EXPIRATION DATE
2747	02/27/2020	03/27/2020

**TRACKING NO.**  
 3 branch

**SALESPERSON**  
 Charlie Cohen

ITEM #	DESCRIPTION	QTY	UNIT	TOTAL
<b>Lego Wall</b>	DISCOVERY LEGO WALL 48" X 48" COLOR: TBD	1	923.00	923.00
<b>4702</b>	MINI DISCOVERY TABLE WITH 2 SIDES, OPEN STORAGE, LOCKABLE CASTERS 2 TOPS: LEGO/TRAIN COMBO AND TINKER TOY/FLAT SURFACE	1	3,077.00	3,077.00
<b>FREIGHT</b>	INCLUDES LIFT GATE, INSIDE DELIVERY AND APPOINTMENT	1	510.00	510.00
<b>TOTAL</b>				<b>\$4,510.00</b>

Accepted By

Accepted Date