



ALL SEASONS

Landscaping Contractors

120 Commerce Court • Cheshire, CT 06410 • (860) 953-2471 • (860) 953-2473
An Equal Opportunity Employer

Invasive Vegetation Removal Plan (IVRP)

5/07/2024

Attn: John Brunalli
RE: Weston 0157-0088

Dear Mr. Brunalli

Per your request we have visited the above mentioned work site and our observations are as follows;

- 1) Areas that are slated for control and removal of invasive vegetation have been delineated on site with Pink Ribbon.
- 2) On site, the following invasive species have been identified;
 - Alliaria petiolate (garlic mustard)
 - Artemisia Vulgaris (mugwort)
 - Berberis thunbergii (Japanese barberry)
 - Celastrus orbiculatus (oriental bittersweet)
 - Solanum dulcamara
 - Tussilago farfara
- 2) Any additional invasive vegetation species found on site, that is not listed above, during treatment will be treated per the specifications.
- 3) We will be mechanically cutting down and removing the larger varieties and afterwards we will be applying an application of Rodeo herbicide to all of the smaller invasive species.
- 4) **Removal Methods:**
 - a. Cutting by hand tools (chain saws., loppers, rotary saws)
 - b. Cutting with equipment-grapples-shears
 - c. Cutting with power axe
 - d. Herbicide Application
- 5) **Herbicides to be utilized**
 - a. **Rodeo**
 - i. EPA REG # #62719-324 **Rodeo**
 - ii. TARGET Nonselective weeds & grasses
 - iii. Apply with hand held sprayer as a 1 ½ % solution.
 - iv. 2 fl. oz. of Rodeo concentration to 1 gal. of water

Treatment Period

1. Initial removal and herbicide application – Spring 2024
2. 14-30 days following initial treatment review & re-treat (if necessary, during the growing season June 1st – September 30th)
3. 1 Year Warranty Period – review & retreat (if necessary)

Construction Activities Planned

See general contractor



ALL SEASONS

Landscaping Contractors

120 Commerce Court • Cheshire, CT 06410 • (860) 953-2471 • (860) 953-2473
An Equal Opportunity Employer

Disposal Methods

- A. Chipped species
 - a. Store in ASL yard 120 Commerce Court, Cheshire, CT 06410

Safety Equipment

- 1. Safety goggles
- 2. Rubber Gloves
- 3. Ear Plugs (chain saw operation)
- 4. Chaps (situational)

Spill Protection

- All crews to be supplied with spill kits which minimally will contain
 - Universal heavyweight sonic bonded pads
 - Universal sorbent socks
 - Yellow disposal bags and ties
 - Nitrile gloves
 - Safety goggles
 - Tamper proof labels
 - Vinyl spill kit label
 - White 5-gallon over-pack with screw top lid
- In the event of a spill:
 - Stop flow
 - Contact CT-DEP Oil & Chemical Spill Response Division 860-424-3338
 - Containment
- For spills that occur
 - the spill is to navigable waters or the adjoining shoreline
 - water quality standards could be violated,
 - the spill causes a sheen or discoloration,
 - the spill causes a sludge or emulsion.
 - Contact-National Response Center at (800) 424- 8802
 - Information to be provided (see next page)
 - Name, location, and telephone number
 - Name and address of the party responsible for the incident
 - Date and time of the incident
 - Location of the incident
 - Source and cause of the release or spill
 - Types of materials released or spilled
 - Quantity of material released or spilled
 - Danger or threat posed by the release or spill
 - Number and type of injuries (if any)
 - Weather conditions at the incident location
 - Any other information that may help emergency personnel respond to the incident.

Sincerely,
Louis LaVecchia
All Seasons Landscaping Inc.
PMCS.0065415



ALL SEASONS

Landscaping Contractors

120 Commerce Court • Cheshire, CT 06410 • (860) 953-2471 • (860) 953-2473
An Equal Opportunity Employer

Lookup Detail View

Contact Information

Name
DAVID P. BAILEY

Certification Information

Registration No.	Type	Effective Date	Expiration Date	Status
PMCO.0022197	Pesticide Commercial Operator Certification	02/01/2021	01/31/2026	ACTIVE



State of Connecticut

Lookup Detail View

Contact Information

Name
LOU STEPHEN LAVECCHIA

Certification Information

PESTICIDE COMMERCIAL SUPERVISOR

Registration No.	Pesticide Category Certification(S)	Effective Date	Expiration Date	Status
PMCS.0065415	3A Ornamentals & Turf, 3D Arborist, 6 Rights-of-Way	03/15/2022	01/31/2027	ACTIVE

Generated on: 2/23/2024 9:23:48 AM



**Department of Energy and Environmental Protection
Pesticide Management Program
Business Registration Certificate**

ALL SEASONS LANDSCAPING, INC.
120 Commerce Ct
1st Fl
Cheshire, CT 06410-1253

This certifies that

ALL SEASONS LANDSCAPING, INC.

120 COMMERCE CT CHESHIRE, CT 06410-1253

Is registered as a

Commercial Pesticide Application Business

With the Commissioner of Energy and Environmental Protection
In accordance with Connecticut General Statutes Section 22a-66c
To perform services in the following certification categories:

3A Ornamentals & Turf; 3D Arborist; 6 Rights-of-Way

Business Registration No: **PMBR.00419**

Issue Date: **09/01/2023**

Expiration Date: **08/31/2024**

Katie Dykes, Commissioner

*****Renewal notices are sent by email ONLY. Please mark your calendar as a reminder to avoid potential late fees.***

REV	DATE	REVISION DESCRIPTION

DESIGNED BY: **DAVID M. GARDNER** CHECKED BY: **DAVID M. GARDNER**
 DRAWN BY: **DAVID M. GARDNER** DATE: **07/18/2023**

PROJECT: **REPLACEMENT OF BRIDGE NO. 07001 MICHAEL'S WAY OVER WEST BRANCH SAUGATUCK RIVER**

SCALE: **1" = 20'**

TOWN OF **WESTON, CT.**

DRAWING TITLE: **PERMIT PLANTING PLAN**

PROJECT NUMBER: **01232088**
 PROJECT LOCATION: **REPLACEMENT OF BRIDGE NO. 07001 MICHAEL'S WAY OVER WEST BRANCH SAUGATUCK RIVER**
 TOWN: **WESTON**
 DRAWING DATE: **07/18/2023**

BOTANICAL NAME	COMMON NAME	SIZE	QTY	SPACING	WETLAND INDICATOR
<i>Thuja occidentalis</i>	Common Arborvitae	18'-24" HT. 1.8"	10	FIELD LOCATED	FAC
<i>Asplenium platyneuron</i>	Common Spotted Fern	2'-3" HT. 1.8"	5	FIELD LOCATED	FACV
<i>Conium maculatum</i>	Swamp Dogwood	18'-24" HT. 1.8"	5	FIELD LOCATED	FACV
<i>Asplenium platyneuron</i>	Swamp Milkweed	1' Gd. 1.8"	20	FIELD LOCATED	OBL
<i>Asplenium platyneuron</i>	Butterfly Milkweed	1' Gd. 1.8"	20	FIELD LOCATED	UPL
TOTAL			40		

SCHEMATIC PLANTING

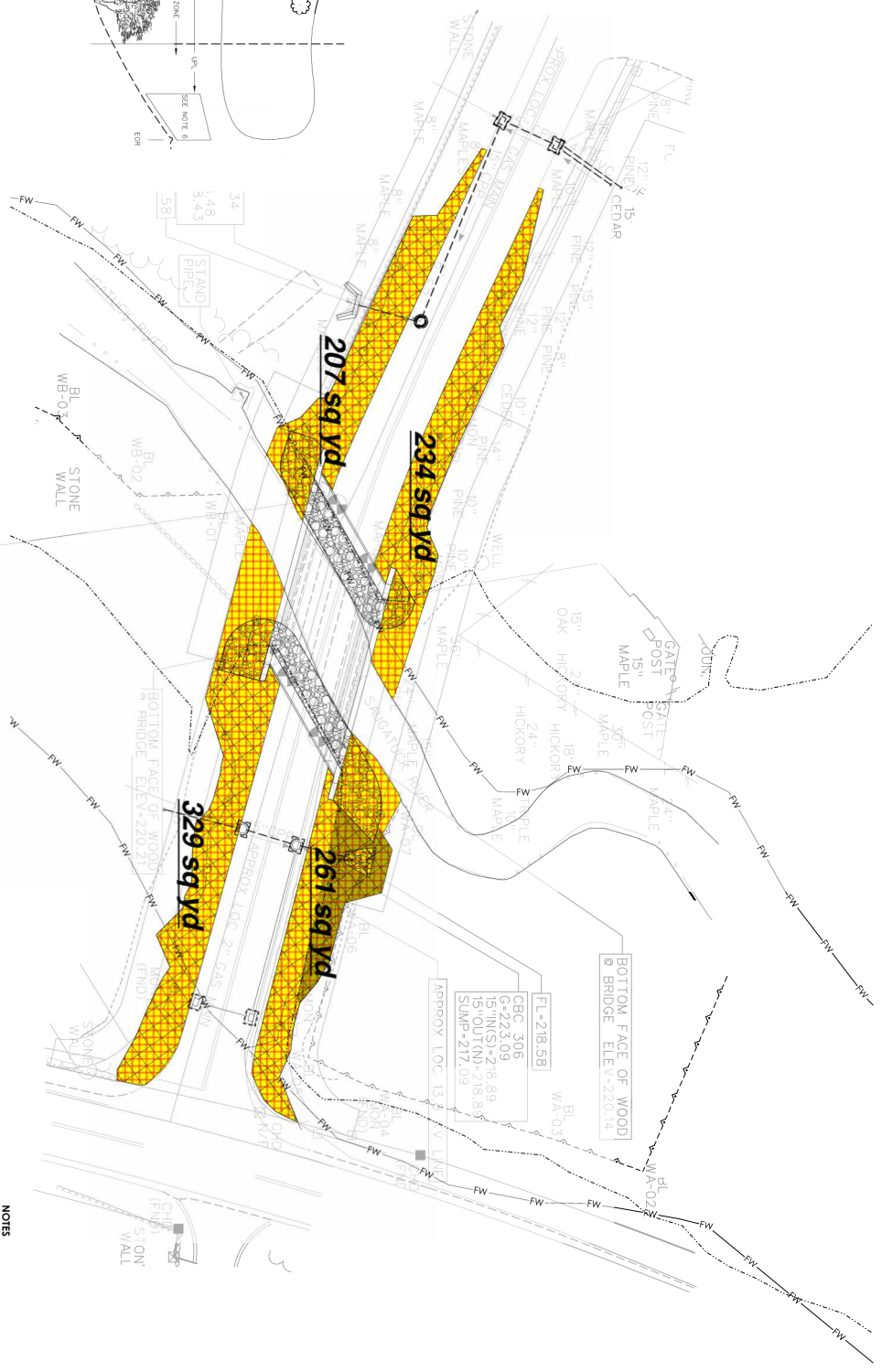
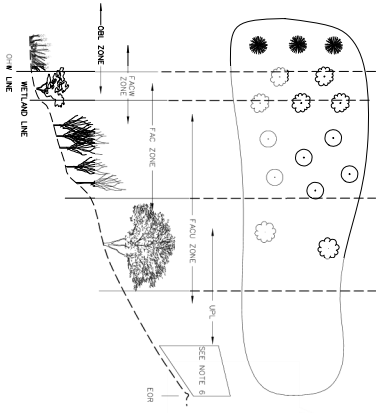

LEGEND

- BRUSH PROTECTION
- CONTROL AND REMOVAL OF INVASIVE VEGETATION (SEE NOTE 7)
- AREA TO BE RESTORED WITH PLANTINGS
- TOTAL PLANTING AREA = 83.5 Y.
- STATE/FEDERAL WETLANDS
- OPEN/AR. HIGH WATER
- EDGE OF STREAM
- REAL TOODWAY LIMIT

NOTES

1. PLANTINGS ON THIS SHEET ARE FOR ENVIRONMENTAL PERMITTING.
2. PROPOSED PLANTINGS TO BE FIELD LOCATED.
3. WOOD CHIP MULCH SHALL NOT BE PLACED IN THE WETLAND AREA AROUND THE PLANTINGS PER STANDARD DETAIL.
4. DISTURBED AREAS BELOW THE WETLAND LIMIT SHALL BE RESEED WITH UPL AND GRASS ESTABLISHMENT. DISTURBED AREAS ABOVE THE WETLAND LIMIT SHALL BE RESEED WITH CONSERVATION SEEDING FOR SLOPES OR OTHER SEED MIX AS SPECIFIED. ALL AREAS SHALL BE RESTORED.
5. ALL PLANT MATERIAL SHALL BE NURSERY GRADE STRAIGHT STEMS, NURSERY STOCK, NO VARIETIES OR CULTIVARS WILL BE ACCEPTED.
6. NO PLANTINGS TO BE PLACED IN A DROWNED AREA.
7. AREAS TO BE TREATED FOR INVASIVES AND PROPERLY REPAIRED FOR WALL PLANTINGS, SEEDINGS AND RESTORATION.

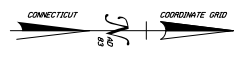

DATE PLOTTED:	05/02
SCALE:	1" = 20'
PROJECT:	01232088
TOWN:	WESTON
DRAWING TITLE:	PERMIT PLANTING PLAN

Invasive Vegetation Waste Disposal - 120 Commerce Court, Cheshire, CT 06410

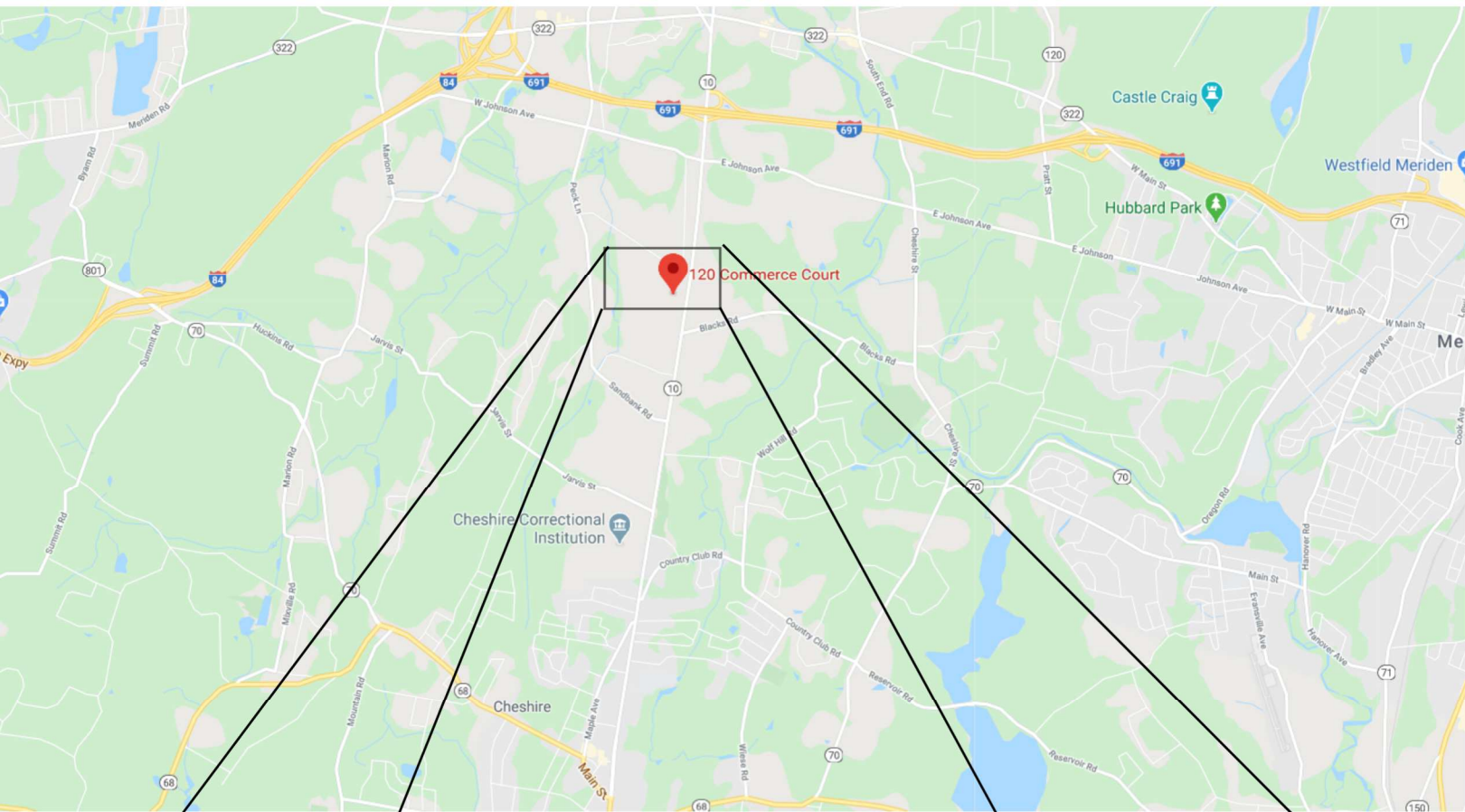

Invasive Vegetation is stockpiled and covered at this location - No Permits are required for the stockpiling of Vegetation

MATERIAL SAFETY DATA SHEET



Emergency Phone: 800-992-5994
Dow AgroSciences LLC
Indianapolis, IN 46268

RODEO* HERBICIDE

Effective Date: 3/23/04
Product Code: 84825
MSDS: 006694

1. PRODUCT AND COMPANY IDENTIFICATION:

PRODUCT: Rodeo* Herbicide

COMPANY IDENTIFICATION:

Dow AgroSciences LLC
9330 Zionsville Road
Indianapolis, IN 46268-1189

2. COMPOSITION/INFORMATION ON INGREDIENTS:

Glyphosate IPA: N-(phosphono-methyl) glycine, Isopropylamine Salt	CAS # 038641-94-0	53.8%
Balance, Total		46.2%

3. HAZARDOUS IDENTIFICATIONS:

EMERGENCY OVERVIEW

Clear, pale yellow liquid. May cause eye irritation. Slightly toxic to aquatic organisms.

EMERGENCY PHONE NUMBER: 800-992-5994

4. FIRST AID:

EYE: Flush eyes thoroughly with water for several minutes. Remove contact lenses after initial 1-2 minutes and continue flushing for several additional minutes. If effects occur, consult a physician, preferably an ophthalmologist.

SKIN: Wash skin with plenty of water.

INGESTION: No emergency medical treatment necessary.

INHALATION: Remove person to fresh air; if effects occur, consult a physician.

NOTE TO PHYSICIAN: No specific antidote. Treatment of exposure should be directed at the control of symptoms and the clinical condition of the patient.

5. FIRE FIGHTING MEASURES:

FLASH POINT: >214°F (>101°C)

METHOD USED: Setaflash

FLAMMABLE LIMITS:

LFL: Not applicable
UFL: Not applicable

EXTINGUISHING MEDIA: Foam, CO₂, Dry Chemical

FIRE AND EXPLOSION HAZARDS: Foam fire extinguishing system is preferred because uncontrolled water can spread possible contamination. Toxic irritating gases may be formed under fire conditions.

FIRE-FIGHTING EQUIPMENT: Use positive-pressure, self-contained breathing apparatus and full protective equipment.

6. ACCIDENTAL RELEASE MEASURES:

ACTION TO TAKE FOR SPILLS: Absorb small spills with an inert absorbent material such as Hazorb, Zorbball, sand, or dirt. Report large spills to Dow AgroSciences on 800-992-5994.

7. HANDLING AND STORAGE:

PRECAUTIONS TO BE TAKEN IN HANDLING AND STORAGE: Keep out of reach of children. Do not swallow. Avoid contact with eyes, skin, and clothing. Avoid breathing vapors and spray mist. Handle concentrate in ventilated area. Wash thoroughly with soap and water after handling and before eating, chewing gum, using tobacco, using the toilet or smoking. Keep away from food, feedstuffs, and water supplies. Store in original container with the lid tightly closed. Store above 10°F (-12°C) to keep from crystallizing.

8. EXPOSURE CONTROLS/PERSONAL PROTECTION:

These precautions are suggested for conditions where the potential for exposure exists. Emergency conditions may require additional precautions.

EXPOSURE GUIDELINES: None established

ENGINEERING CONTROLS: Good general ventilation should be sufficient for most conditions. Local exhaust ventilation may be necessary for some operations.

RECOMMENDATIONS FOR MANUFACTURING, COMMERCIAL BLENDING, AND PACKAGING WORKERS:

EYE/FACE PROTECTION: Use safety glasses.

SKIN PROTECTION: No precautions other than clean body-covering clothing should be needed.

MATERIAL SAFETY DATA SHEET



Emergency Phone: 800-992-5994
Dow AgroSciences LLC
Indianapolis, IN 46268

RODEO* HERBICIDE

Effective Date: 3/23/04
Product Code: 84825
MSDS: 006694

RESPIRATORY PROTECTION: For most conditions, no respiratory protection should be needed; however, if discomfort is experienced, use a NIOSH approved air-purifying respirator.

APPLICATIONS AND ALL OTHER HANDLERS: Please refer to the product label for personal protective clothing and equipment.

9. PHYSICAL AND CHEMICAL PROPERTIES:

APPEARANCE: Clear, pale yellow liquid

DENSITY: 10.0 - 10.5 lbs/gal

pH: 4.8 - 5.0

ODOR: None

SOLUBILITY IN WATER: Miscible

SPECIFIC GRAVITY: 1.21 gm/L

FREEZING POINT: -7°F - -10°F (-21°C - -25°C)

10. STABILITY AND REACTIVITY:

STABILITY: (CONDITIONS TO AVOID) Stable under normal storage conditions.

INCOMPATIBILITY: (SPECIFIC MATERIALS TO AVOID) Galvanized or unlined steel (except stainless steel) containers or spray tanks may produce hydrogen gas which may form a highly combustible gas mixture.

HAZARDOUS DECOMPOSITION PRODUCTS: None known.

HAZARDOUS POLYMERIZATION: Not known to occur.

11. TOXICOLOGICAL INFORMATION:

EYE: May cause slight temporary eye irritation. Corneal injury is unlikely.

SKIN: Essentially non-irritating to skin. Prolonged skin contact is unlikely to result in absorption of harmful amounts. The LD₅₀ for skin absorption in rabbits is >5000 mg/kg. Did not cause allergic skin reactions when tested in guinea pigs.

INGESTION: Very low toxicity if swallowed. Harmful effects not anticipated from swallowing small amounts. The oral LD₅₀ for rats is >5000 mg/kg.

INHALATION: Brief exposure (minutes) is not likely to cause adverse effects. The aerosol LC₅₀ for rats is >6.37 mg/L for 4 hours.

SYSTEMIC (OTHER TARGET ORGAN) EFFECTS: For a similar material, glyphosate, in animals, effects have been reported on the following organ: liver.

CANCER INFORMATION: A similar material, glyphosate, did not cause cancer in laboratory animals.

TERATOLOGY (BIRTH DEFECTS): For glyphosate IPA, available data are inadequate for evaluation of potential to cause birth defects.

REPRODUCTIVE EFFECTS: For glyphosate IPA, available data are inadequate to determine effects on reproduction.

MUTAGENICITY: For a similar material, glyphosate, in-vitro and animal genetic toxicity studies were negative.

12. ECOLOGICAL INFORMATION:

ENVIRONMENTAL DATA:

ECOTOXICOLOGY:

Material is practically non-toxic to aquatic organisms on an acute basis (LC₅₀ or EC₅₀ is >100 mg/L in most sensitive species tested).

Acute LC₅₀ for rainbow trout (*Oncorhynchus mykiss*) is >2500 mg/L.

Acute immobilization EC₅₀ in water flea (*Daphnia magna*) is 918 mg/L.

Material is practically non-toxic to birds on an acute basis (LD₅₀ is >2000 mg/kg).

Acute oral LD₅₀ in bobwhite (*Colinus virginianus*) is >2000 mg/kg.

The LC₅₀ in earthworm *Eisenia foetida* is >1000 mg/kg.

Acute contact LD₅₀ in honey bee (*Apis mellifera*) is >100 µg/bee.

Acute oral LD₅₀ in honey bee (*Apis mellifera*) is >100 µg/bee.

Growth inhibition EC₅₀ in green alga (*Selenastrum capricornutum*) is 127 mg/L.

Growth inhibition EC₅₀ in duckweed (*Lemna sp.*) is 24.4 mg/L.

13. DISPOSAL CONSIDERATIONS:

DISPOSAL METHOD: If wastes and/or containers cannot be disposed of according to the product label directions, disposal of this material must be in accordance with your local or area regulatory authorities.

MATERIAL SAFETY DATA SHEET



Emergency Phone: 800-992-5994
Dow AgroSciences LLC
Indianapolis, IN 46268

RODEO* HERBICIDE

Effective Date: 3/23/04
Product Code: 84825
MSDS: 006694

This information presented below only applies to the material as supplied. The identification based on characteristic(s) or listing may not apply if the material has been used or otherwise contaminated. It is the responsibility of the waste generator to determine the toxicity and physical properties of the material generated to determine the proper waste identification and disposal methods in compliance with applicable regulations.

If the material as supplied becomes a waste, follow all applicable regional, national and local laws and regulations.

14. TRANSPORT INFORMATION:

U.S. DEPARTMENT OF TRANSPORTATION (DOT) INFORMATION:

For all package sizes and modes of transportation:
This material is not regulated for transport.

15. REGULATORY INFORMATION:

NOTICE: The information herein is presented in good faith and believed to be accurate as of the effective date shown above. However, no warranty, express or implied, is given. Regulatory requirements are subject to change and may differ from one location to another; it is the buyer's responsibility to ensure that its activities comply with federal, state or provincial, and local laws. The following specific information is made for the purpose of complying with numerous federal, state or provincial, and local laws and regulations.

U.S. REGULATIONS

SARA 313 INFORMATION: To the best of our knowledge, this product contains no chemical subject to SARA Title III Section 313 supplier notification requirements.

SARA HAZARD CATEGORY: This product has been reviewed according to the EPA "Hazard Categories" promulgated under Sections 311 and 312 of the Superfund Amendment and Reauthorization Act of 1986 (SARA Title III) and is considered, under applicable definitions, to meet the following categories:

Not to have met any hazard category

TOXIC SUBSTANCES CONTROL ACT (TSCA): All ingredients are on the TSCA inventory or are not required to be listed on the TSCA inventory.

STATE RIGHT-TO-KNOW: This product is not known to contain any substances subject to the disclosure requirements of

New Jersey
Pennsylvania

OSHA HAZARD COMMUNICATION STANDARD: This product is a "Hazardous Chemical" as defined by the OSHA Hazard Communication Standard, 29 CFR 1910.1200.

COMPREHENSIVE ENVIRONMENTAL RESPONSE COMPENSATION AND LIABILITY ACT (CERCLA, or SUPERFUND): To the best of our knowledge, this product contains no chemical subject to reporting under CERCLA.

NATIONAL FIRE PROTECTION ASSOCIATION (NFPA) RATINGS:

<u>CATEGORY</u>	<u>RATING</u>
Health	1
Flammability	1
Reactivity	0

16. OTHER INFORMATION:

MSDS STATUS: Revised Sections: 3,4,11,12,13,14 & 15
Reference: DR-0361-8028
Replaces MSDS Dated: 1/12/00
Document Code: D03-148-002
Replaces Document Code: D03-148-001

The Information Herein Is Given In Good Faith, But No Warranty, Express Or Implied, Is Made. Consult Dow AgroSciences For Further Information.

Identified Invasives @ Micheals Way Bridge Project

5/7/2024



• *Alliaria petiolate* (garlic mustard)



• *Celastrus orbiculatus* (oriental bittersweet)



• *Artemisia Vulgaris* (mugwort)



• *Solanum dulcamara* (bittersweet night shade)



• *Berberis thunbergii* (Japanese barberry)



• *Tussilago farfara* (coltsfoot)

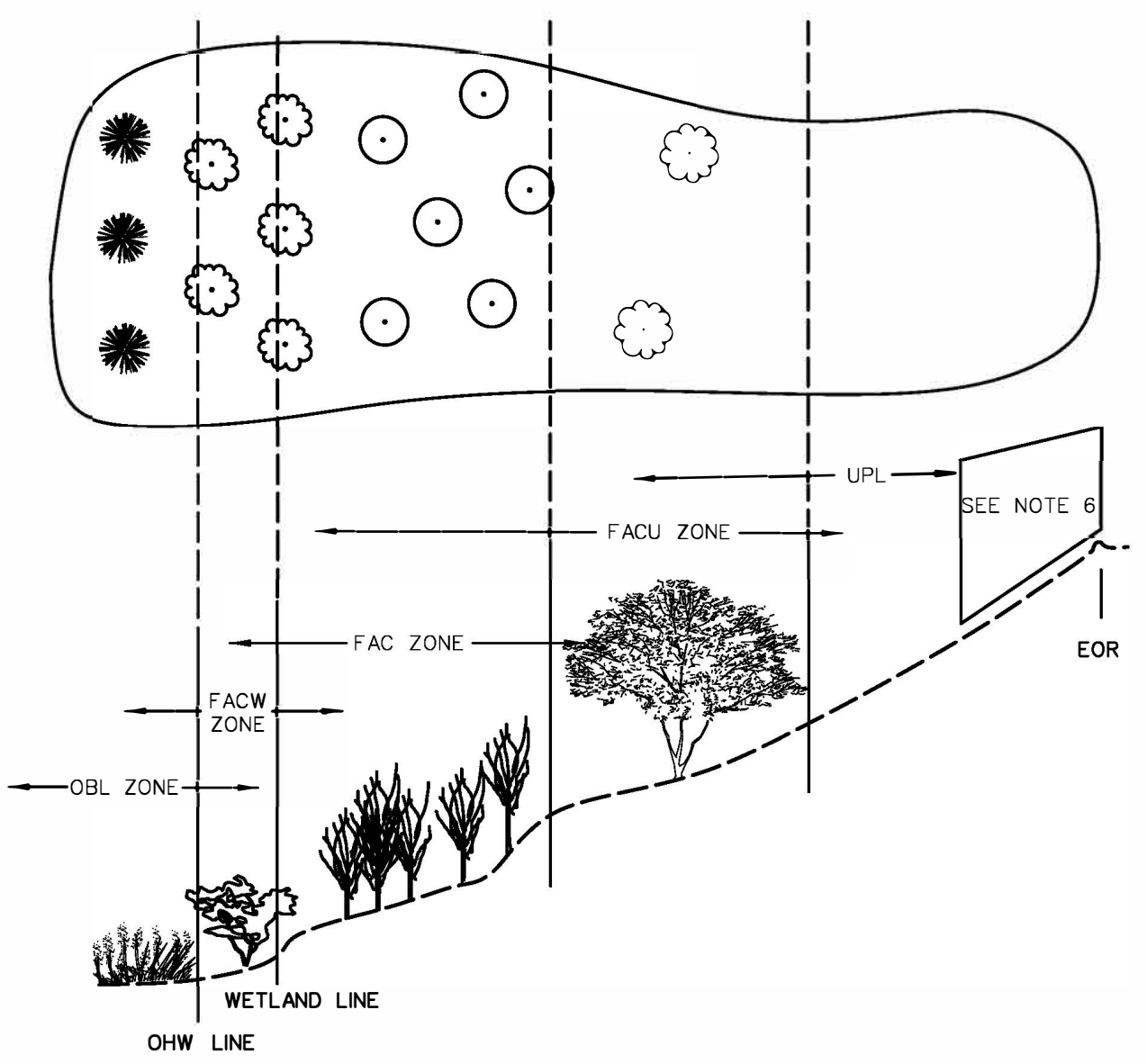
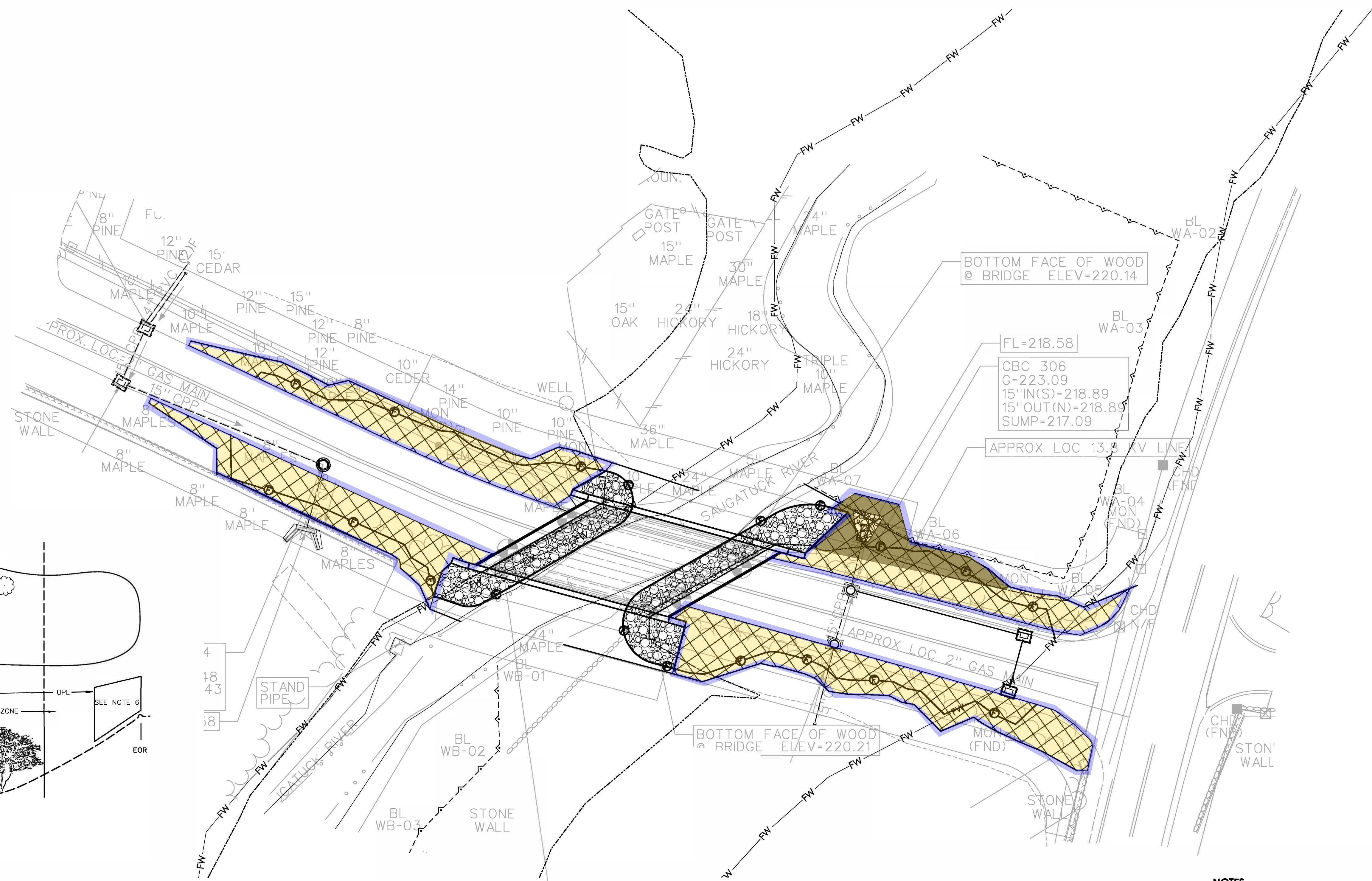
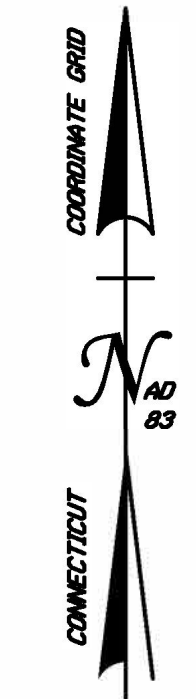

SCHEMATIC PLANTING

PERMIT PLANT LIST

BOTANICAL NAME	COMMON NAME	SIZE	QTY.	SPACING	WETLAND INDICATOR
<i>Lindera benzoin</i>	Common Spicebush	18"-24" HT. B.B.	10	Field Located	FAC
<i>Baccharis halimifolia</i>	Groundsel Tree	2'-3' HT. B.B.	5	Field Located	FACW
<i>Cornus amomum</i>	Silky Dogwood	18"-24" HT. Container	5	Field Located	FACW
<i>Asclepias incarnata</i>	Swamp Milkweed	2" Plug	20	Field Located	OBL
<i>Asclepias tuberosa</i>	Butterfly Milkweed	2" Plug	20	Field Located	UPL
TOTAL			60		

LEGEND

- RIPRAP PROTECTION
- CONTROL AND REMOVAL OF INVASIVE VEGETATION (SEE NOTE 7)
- AREA TO BE RESTORED WITH PLANTINGS
- STATE/FEDERAL WETLANDS
- ORDINARY HIGH WATER
- EDGE OF STREAM
- FEMA FLOODWAY LIMIT
- 100-YEAR FEMA (CALCULATED)

TOTAL PLANTS = 60
TOTAL PLANTING AREA = 85 S.Y.

NOTES

1. PLANTINGS ON THIS SHEET ARE FOR ENVIRONMENTAL PERMITTING.
2. PROPOSED PLANTINGS TO BE FIELD LOCATED.
3. WOOD CHIP MULCH SHALL NOT BE PLACED IN THE WETLAND AREA. ABOVE THE WETLAND AREA THE WOOD CHIP MULCH IS TO BE PLACED AROUND THE PLANTINGS, PER STANDARD DETAIL.
4. DISTURBED AREAS BELOW THE WETLAND LIMIT SHALL BE SEEDED WITH WETLAND GRASS ESTABLISHMENT. DISTURBED AREAS ABOVE THE WETLAND LIMIT SHALL BE SEEDED WITH CONSERVATION SEEDING FOR SLOPES, OR OTHER SEED MIX AS SPECIFIED. ALL AREAS SHALL BE RESTORED.
5. ALL PLANT MATERIAL SHALL BE NURSERY GRADE STRAIGHT SPECIES, CONFORMING TO SECTION 3 OF THE AMERICAN STANDARDS FOR NURSERY STOCK. NO VARIETIES OR CULTIVARS WILL BE ACCEPTED.
6. NO PLANTINGS TO BE PLACED IN A MOWED AREA.
7. **AREA TO BE TREATED FOR INVASIVES AND PROPERLY REPAIRED FOR FINAL PLANTING, SEEDING, AND RESTORATION.**

REV.	DATE	REVISION DESCRIPTION

ENVIRONMENTAL PERMIT PLANS
DATED: 7/11/2023

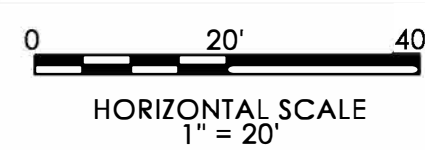

SIGNATURE/BLOCK:

TOWN OF WESTON, CT.

PROJECT NUMBER: 0157-0088
PROJECT DESCRIPTION: REPLACEMENT OF BRIDGE NO. 07001 MICHAEL'S WAY OVER WEST BRANCH SAUGATUCK RIVER
TOWN(S): WESTON
DRAWING TITLE: PERMIT PLANTING PLAN

DRAWING NO. PMT-07
SHEET NO.