



To: Members of the Planning and Zoning Commission
From: Samantha Nestor, First Selectwoman 
Subject: Pickle Ball Courts
Date: January 22, 2024

I submit on behalf of the Board of Selectmen a referral for a report seeking the Planning and Zoning Commission's concurrence under Connecticut General Statutes Section 8-24 for improvements associated with the implementation of Pickleball Courts.

The Parks and Recreation Commission and Department searched for locations where the Pickleball courts could be constructed. Various parcels were studied and were deemed potentially inappropriate due either the future planning needs of the Facilities Optimization committee or location issues.

Other areas were deemed to not have parking capability and needed too much groundwork to clear. (property between Hurlbutt core building and the Norfield Church)

The newest proposed Location was identified to be Bisceglie–Scribner Park which is an active park that has adequate parking in place and is located in a central proximity to the Town baseball fields, a picnic pavilion, an active playground and the Town swimming pond.

Bisceglie Park has a .20 acre area located directly off of the walking path to the pond and close to the parking lot which is surrounded by split rail fence. This parcel will require some groundwork to be performed and will be able to accommodate 2 to 4 pickle ball courts. Weston Parks and Recreation will maintain the courts and portable aluminum bench seating areas will be provided for the facility. This project will provide a fun recreation area for the entire town.

The Board of Selectmen seeks a positive CGS Section 8-24 referral from the Planning and Zoning Commission.

Encl: Parks and Recreation Presentation to Board of Selectmen 1/18/2024
Preliminary Site Development Plan Dated January 4, 2024

PICKLEBALL

AT BISCEGLIE – SCRIBNER PARK



HISTORY: PICKLE BALL POPULARITY AND FUNDING

- Pickleball is the most publicly requested activity of the Parks & Recreation Department
- Construction of Town Pickleball courts was the number one priority for the Parks & Recreation Commission in the Town Capital budget for the 2022-2023 Budget.
- Pickleball is the fastest growing sport in the country.
- The Town received ARPA funds for various needed Town projects.
- The Town BOS and BOF approved the distribution of ARPA funding which included Pickle ball courts.
- The ARPA projects were then approved by the Special Town Meeting machine ballot vote in June 2022.
- Any costs outside the ARPA funds will be paid for by the Enterprise Fund.

HISTORY: WHY BISCEGLIE – SCRIBNER PARK ?

- The Parks & Recreation Commission and Department searched for locations where the Pickleball courts could be constructed. Various parcels were studied and were deemed potentially inappropriate due either the future planning needs of the Facilities Optimization committee or location issues.
- Other areas were deemed to not have parking capability and needed too much groundwork to clear. (property between Hurlbutt core building and the Norfield Church)
- The newest proposed Location was identified to be Bisceglie – Scribner Park which is an active park that has adequate parking in place and is located in a central proximity to the Town baseball fields, a picnic pavilion, an active playground and the Town swimming pond.
- Bisceglie Park has a .20 acre area located directly off of the walking path to the pond and close to the parking lot which is surrounded by split rail fence. This parcel will require some groundwork to be performed and will be able to accommodate 2 to 4 pickle ball courts.
- Weston Parks & Recreation will maintain the courts and portable aluminum bench seating areas will be provided for the facility.

PICKLE BALL COURTS

- The project area is located in an active park, has adequate gravel parking, woodland areas, and is a centrally located Town Park.
- The proposed site development includes the construction of new pickle ball courts with a drainage system in an area that currently exists as a wooded walking trail.
- The courts will be surrounded by a chain link perimeter fence with wind screen mesh. Benches for seating will be provided.
- To facilitate the pickleball courts a small portion of the wooded area will need to be removed.
- There are no homes located near this proposed area at Bisceglie.

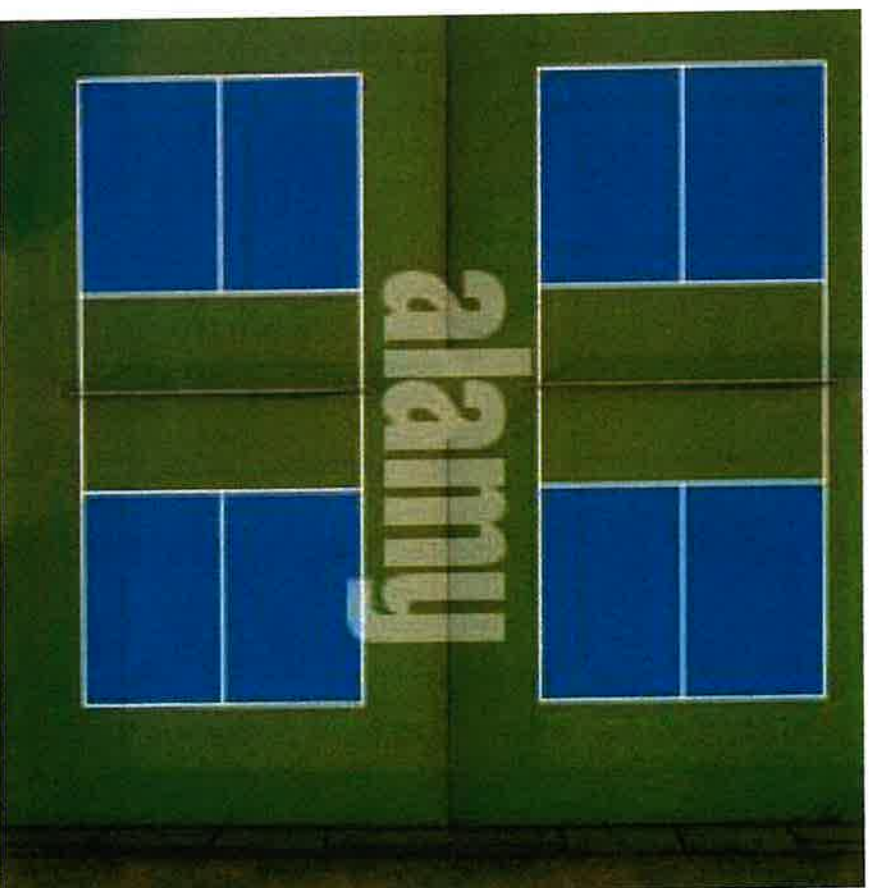

THANK YOU

WESTON PARKS & RECREATION
COMMISSION



PRELIMINARY
NOT FOR CONSTRUCTION

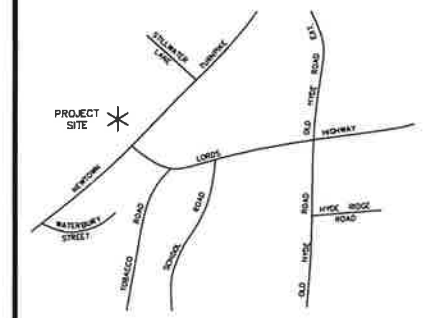
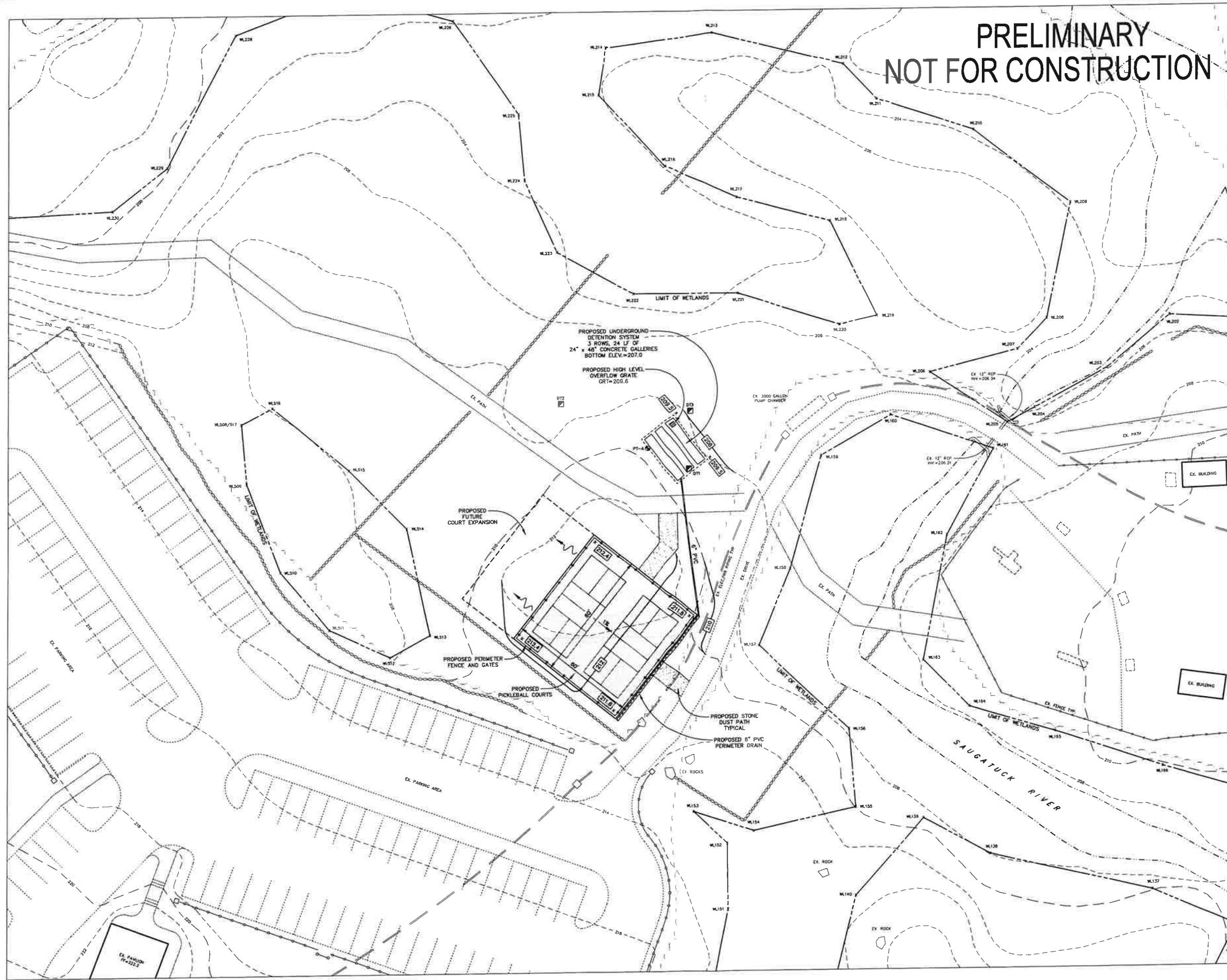

SCALE: 1" = 1000'

Orientation

| No. | Date | Revisions or Submissions |
|-----|------|--------------------------|
| | | |
| | | |
| | | |
| | | |
| | | |
| | | |
| | | |
| | | |
| | | |
| | | |



THIS DRAWING AND DETAILS ON IT, AS AN INSTRUMENT OF SERVICE, IS THE PROPERTY OF THE ENGINEER AND MAY BE USED FOR THIS SPECIFIC PROJECT AND SHALL NOT BE LOANED, COPIED OR REPRODUCED WITHOUT THE WRITTEN CONSENT OF THE ENGINEER.

McChord Engineering Associates, Inc.
Civil Engineers and Land Planners
1 Grumman Hill Road
Wilton, CT 06897 (203) 834-0569

PLAN PREPARED FOR
TOWN OF WESTON
WESTON, CONNECTICUT

SITE DEVELOPMENT PLAN
PICKLEBALL COURTS, BISCEGLIE PARK
WESTON, CONNECTICUT

JOB NO.: 2332A-1 DATE: JANUARY 4, 2024
DRAWN BY: DRS CHECKED BY: TSN, HMR
SCALE: 1" = 20'



SIGNATURE: _____

DRAWING NO.:
SE1

THIS PRINT IS INVALID WITHOUT EMBOSSED OR LIVE RED SEAL. SHEET X OF X